



COMPOSITE COMPUTER REGISTER UNDER LAND TRANSFER ACT 1952



R. W. Muir
Registrar-General
of Land

Search Copy

Identifier NA40D/510
Land Registration District North Auckland
Date Issued 21 October 1977

Prior References

NA835/102

Estate Fee Simple - 1/5 share
Area 1358 square metres more or less
Legal Description Lot 101 Deposited Plan 12307

Proprietors

Richard Watson Patrick

| | | | |
|---------------|-----------|-------------------|---|
| Estate | Leasehold | Instrument | L 462423.5 |
| | | Term | 999 years as from and including 4.10.1977 |

Legal Description Flat 5 Deposited Plan 84340

Proprietors

Richard Watson Patrick

Interests

Subject to a drainage right (in gross) in favour of the Waitemata County Council created by Transfer 150941 (Affects Fee Simple)

- 462423.1 Lease of Flat 1 Composite CT NA40D/506 issued - 21.10.1977 (Affects Fee Simple)
- 462423.2 Lease of Flat 2 Composite CT NA40D/507 issued - 21.10.1977 (Affects Fee Simple)
- 462423.3 Lease of Flat 3 Composite CT NA40D/508 issued - 21.10.1977 (Affects Fee Simple)
- 462423.4 Lease of Flat 4 Composite CT NA40D/509 issued - 21.10.1977 (Affects Fee Simple)
- 462423.5 Lease of Flat 5 DP 84340 Term 999 years as from and including 4.10.1977 Composite CT NA40D/510 issued - 21.10.1977 (Affects Fee Simple)
- C529523.1 Variation of Lease 462423.1 - 21.10.1993 at 11.23 am (Affects Fee Simple)
- C529523.2 Variation of Lease 462423.2 - 21.10.1993 at 11.23 am (Affects Fee Simple)
- C529523.3 Variation of Lease 462423.3 - 21.10.1993 at 11.23 am (Affects Fee Simple)
- C529523.4 Variation of Lease 462423.4 - 21.10.1993 at 11.23 am (Affects Fee Simple)
- C529523.5 Variation of Lease 462423.5 - 21.10.1993 at 11.23 am

Image Quality due
to Condition
of Original

LAND DISTRICT NORTH AUCKLAND
SURVEY BLM & DIST. III RANGITOTO
SHEET No.

PLAN OF FLATS ON LOT 101 D.P. 12307

LOCAL AUTHORITY TAKAPUNA CITY
Surveyed by MURRAY-NORTH PARTNERS LTD
Scale 1:200 Date JULY 1977

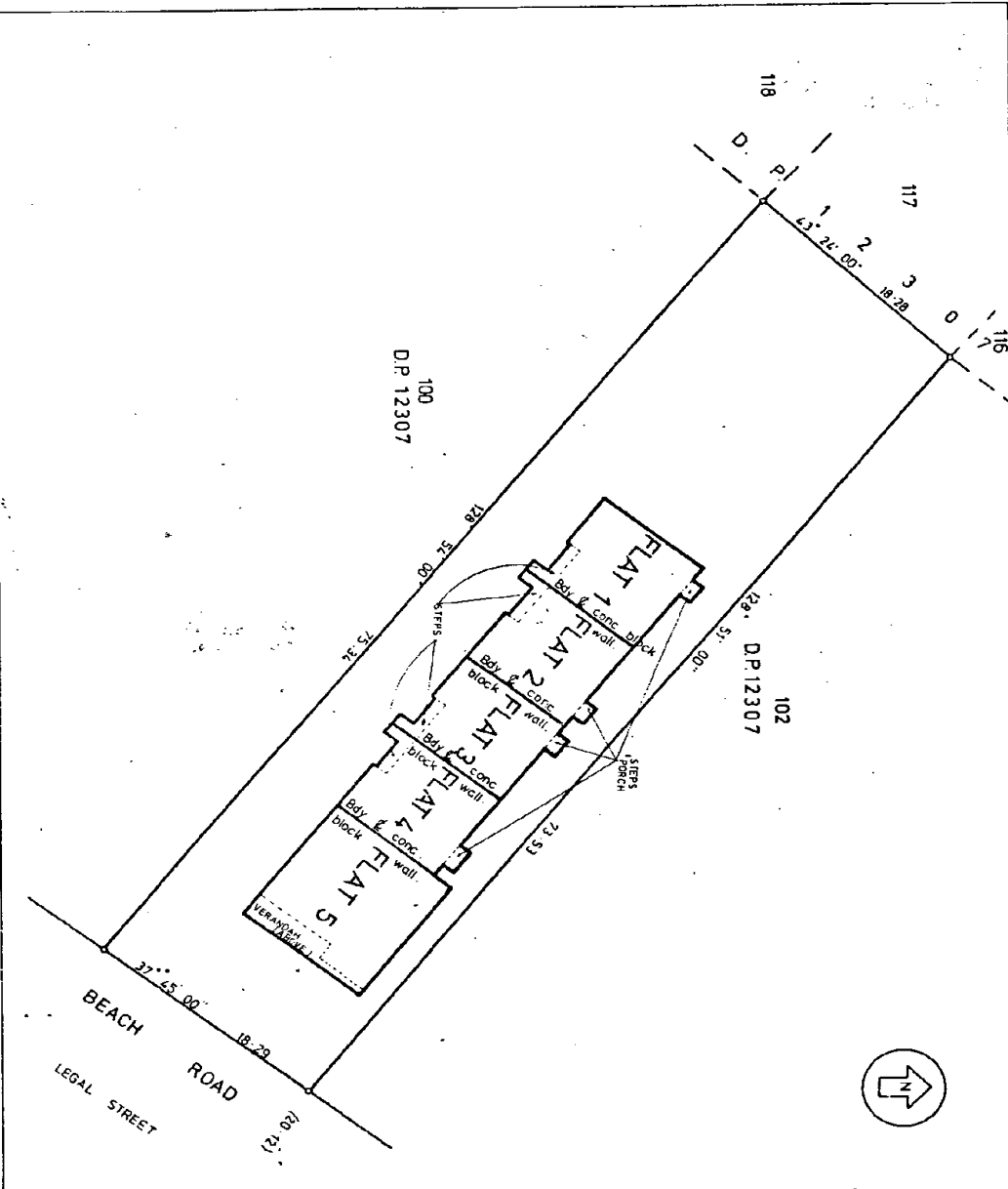

- NEW C&T ALLOCATED.
- FLAT 1 40 D - 506
 - FLAT 2 40 D - 507
 - FLAT 3 40 D - 508
 - FLAT 4 40 D - 509
 - FLAT 5 40 D - 510

NB Boundaries of areas to be leased are to outside faces of walls or structures unless otherwise stated.

Total Area 1358 m²
Compiled in C.T. 835/102 ALL

PETER JOHN ESLING AUCKLAND
I hereby certify that the above is a correct and true copy of the original plan as shown to me and that the same has been made in accordance with the regulations under the Survey Act 1958.
Dated at Auckland this 28th day of July 1977.
Peter John Esling
1977 Surveyor

Estimated E.A. DALLEY
Approved as to Survey for the purposes of the Survey Act 1958.
S. W. 177 Assistant Chief Surveyor

Approved this 12th day of August 1977
S. W. 177 Assistant Chief Surveyor

Approved this 12th day of August 1977
S. W. 177 Assistant Chief Surveyor