



**COMPUTER UNIT TITLE REGISTER  
UNDER LAND TRANSFER ACT 1952**



  
R. W. Muir  
Registrar-General  
of Land

**Search Copy**

**Identifier** NA119B/815  
**Land Registration District** North Auckland  
**Date Issued** 10 June 1998

**Prior References**  
NA107D/343

**Supplementary Record Sheet**  
NA119B/822

---

**Estate** Stratum in Freehold  
**Legal Description** Unit C21 and Accessory Unit 52-53 and  
95 Deposited Plan 189561

**Proprietors**  
Martyn Thomas Baker and Paula Clare Fisher

---

**The above estates are subject to the reservations, restrictions, encumbrances, liens and interests noted below and on the relevant unit plan and supplementary record sheet**

D064351.19 Consent Notice pursuant to Section 221 (1) Resource Management Act 1991 - 6.11.1996 at 11.26 am  
7433157.2 Mortgage to Westpac New Zealand Limited - 5.7.2007 at 10:39 am

Identifier

NA119B/815



**SUPPLEMENTARY RECORD SHEET  
UNDER UNIT TITLES ACT 1972**

Search Copy

Identifier

NA119B/822

Land Registration District

North Auckland

Date Issued

10 June 1998

Plan Number

DP 189561

Subdivision of

Lot 16 Deposited Plan 175192

Prior References

NA107D/343

Unit Titles Issued

NA119B/795	NA119B/796	NA119B/797	NA119B/798
NA119B/799	NA119B/800	NA119B/801	NA119B/802
NA119B/803	NA119B/804	NA119B/805	NA119B/806
NA119B/807	NA119B/808	NA119B/809	NA119B/810
NA119B/811	NA119B/812	NA119B/813	NA119B/814
NA119B/815	NA119B/816	NA119B/817	NA119B/818
NA119B/819	NA119B/820	NA119B/821	

Interests

OWNERSHIP OF COMMON PROPERTY

Pursuant to Section 47 Unit Titles Act 2010 -

(a) the body corporate owns the common property and

(b) the owners of all the units are beneficially entitled to the common property as tenants in common in shares proportional to the ownership interest (or proposed ownership interest) in respect of their respective units.

The above memorial has been added to Supplementary Record Sheets issued under the Unit Titles Act 1972 to give effect to Section 47 of the Unit Titles Act 2010.

Fencing Agreement in Transfer D064351.4 - 6.11.1996 at 11.26 am

Land Covenant in Transfer D064351.4 - 6.11.1996 at 11.26 am

D064351.19 Consent Notice pursuant to Section 221 (1) Resource Management Act 1991 - 6.11.1996 at 11.26 am

Appurtenant hereto is a party wall right specified in Easement Certificate D257859.4 - 1.4.1998 at 12.08 pm

Subject to a party wall right over part marked C on DP 186892 specified in Easement Certificate D257859.4 - 1.4.1998 at 12.08 pm

D279872.4 Change of rules of the Body Corporate - 10.6.1998 at 11.31 am

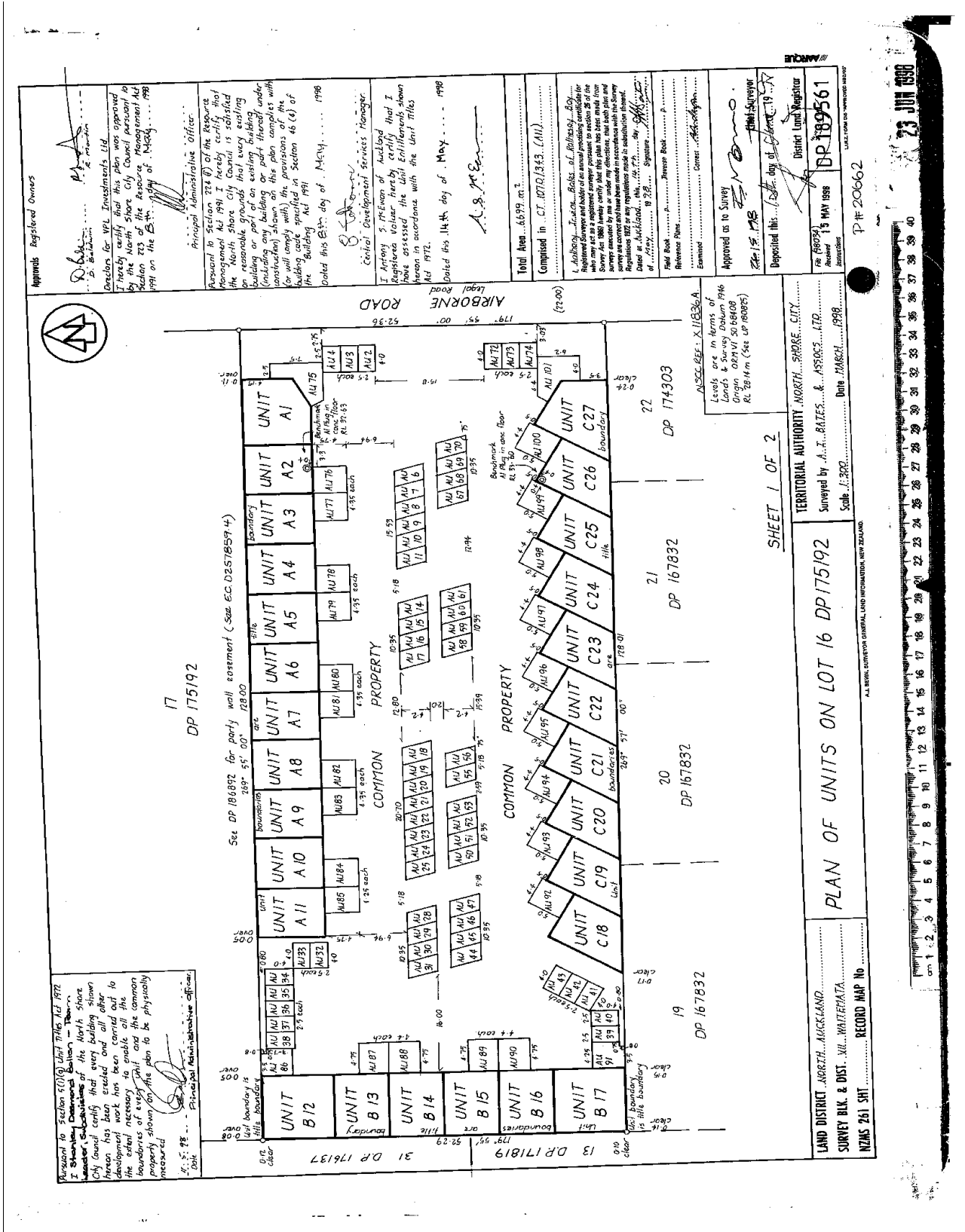

Approved Registered Owners  
 D. B. ...  
 Directors for VPL Investments Ltd.  
 I hereby certify that this plan was approved by the North Shore City Council pursuant to Section 223 of the Resource Management Act 1991 on the 14th day of May, 1998.

Principal Administrative Officer  
 Pursuant to Section 224 of the Resource Management Act 1991 I hereby certify that the North Shore City Council is satisfied on reasonable grounds that existing building or proposed building or part thereof under construction shown on this plan complies with the provisions of the Building Code of New Zealand as specified in Section 46(4) of the Building Act 1991.

Central Development Services Manager  
 I, Anthony S. ... hereby certify that I have assessed the Unit Entitlements shown hereon in accordance with the Unit Titles Act 1972.

Dated this 14th day of May, 1998  
 A.S. ...

Total Area 46,929 sq. m.  
 Comprised in CT 1072/1343 (AU)

Registered Surveyor and holder of an annual practicing certificate for Survey Act 1982  
 I, ... hereby certify that this plan and survey are correct and have been made in accordance with the Survey Regulations 1972 in any regulations made in substitution thereof.

Approved as to Survey  
 Approved as to Survey  
 Deposited this 14th day of May 1998  
 District Land Registrar  
 DP 175192

PLAN OF UNITS ON LOT 16 DP 175192  
 SHEET 1 OF 2  
 TERRITORIAL AUTHORITY NORTH SHORE CITY  
 Surveyed by A.J. BATES & ASSOCIATES LTD  
 Scale 1:300  
 Date 14/05/98

23 JUN 1998

1 2 3 4 5 6 7 8 9 10 11 12 13 14 15 16 17 18 19 20 21 22 23 24 25 26 27 28 29 30 31 32 33 34 35 36 37 38 39 40



SCHEDULE CONTINUED

Apellation	Approx Floor Area (m <sup>2</sup> )	Unit Entitlements	Height Limits Upper Lower	New CT Allocated
AU 41	10	10	37.7 32.7	
AU 42	10	10	37.7 32.7	
AU 43	10	10	36.8 31.8	
AU 44	10	10	36.8 31.8	
AU 45	11	10	36.8 31.8	
AU 46	11	10	36.8 31.8	
AU 47	11	10	36.8 31.8	
AU 48	11	10	36.8 31.8	
AU 49	11	10	36.8 31.8	
AU 50	11	10	36.8 31.8	
AU 51	11	10	36.8 31.8	
AU 52	11	10	36.8 31.8	
AU 53	11	10	36.8 31.8	
AU 54	11	10	36.8 31.8	
AU 55	11	10	36.8 31.8	
AU 56	11	10	36.8 31.8	
AU 57	11	10	36.8 31.8	
AU 58	11	10	36.8 31.8	
AU 59	11	10	36.8 31.8	
AU 60	11	10	36.8 31.8	
AU 61	11	10	36.8 31.8	
AU 62	11	10	36.8 31.8	
AU 63	11	10	36.8 31.8	
AU 64	11	10	36.8 31.8	
AU 65	11	10	36.8 31.8	
AU 66	11	10	36.8 31.8	
AU 67	11	10	36.8 31.8	
AU 68	11	10	36.8 31.8	
AU 69	11	10	36.8 31.8	
AU 70	11	10	36.8 31.8	
AU 71	11	10	36.8 31.8	
AU 72	11	10	36.8 31.8	
AU 73	10	10	37.5 32.5	
AU 74	10	10	37.5 32.5	
AU 75	10	10	37.5 32.5	
AU 76	10	10	37.5 32.5	
AU 77	10	10	37.5 32.5	
AU 78	10	10	37.5 32.5	
AU 79	10	10	37.5 32.5	
AU 80	10	10	37.5 32.5	
AU 81	10	10	37.5 32.5	
AU 82	10	10	37.5 32.5	
AU 83	10	10	37.5 32.5	
AU 84	10	10	37.5 32.5	
AU 85	10	10	37.5 32.5	
AU 86	10	10	37.5 32.5	
AU 87	10	10	37.5 32.5	
AU 88	10	10	37.5 32.5	
AU 89	10	10	37.5 32.5	
AU 90	10	10	37.5 32.5	
AU 91	10	10	37.5 32.5	
AU 92	10	10	37.5 32.5	
AU 93	10	10	37.5 32.5	
AU 94	10	10	37.5 32.5	
AU 95	10	10	37.5 32.5	
AU 96	10	10	37.5 32.5	
AU 97	10	10	37.5 32.5	
AU 98	10	10	37.5 32.5	
AU 99	10	10	37.5 32.5	
AU 100	10	10	37.5 32.5	
AU 101	10	10	37.5 32.5	

Apellation	Approx Floor Area (m <sup>2</sup> )	Unit Entitlements	Height Limits Upper Lower	New CT Allocated
Unit A1	98	421	40.2 32.0	1/19/81/795
Unit A2	75	240	40.2 32.0	1/19/81/796
Unit A3	75	240	40.2 32.0	1/19/81/797
Unit A4	78	260	40.2 32.0	1/19/81/798
Unit A5	78	260	40.2 32.0	1/19/81/799
Unit A6	78	260	40.2 32.0	1/19/81/800
Unit A7	78	260	40.2 32.0	1/19/81/801
Unit A8	78	260	40.2 32.0	1/19/81/802
Unit A9	78	260	40.2 32.0	1/19/81/803
Unit A10	78	260	40.2 32.0	1/19/81/804
Unit A11	78	260	40.2 32.0	1/19/81/805
Unit A12	78	260	40.2 32.0	1/19/81/806
Unit A13	78	260	40.2 32.0	1/19/81/807
Unit A14	78	260	40.2 32.0	1/19/81/808
Unit A15	78	260	40.2 32.0	1/19/81/809
Unit A16	78	260	40.2 32.0	1/19/81/810
Unit A17	78	260	40.2 32.0	1/19/81/811
Unit A18	78	260	40.2 32.0	1/19/81/812
Unit A19	78	260	40.2 32.0	1/19/81/813
Unit A20	78	260	40.2 32.0	1/19/81/814
Unit A21	78	260	40.2 32.0	1/19/81/815
Unit A22	78	260	40.2 32.0	1/19/81/816
Unit A23	78	260	40.2 32.0	1/19/81/817
Unit A24	78	260	40.2 32.0	1/19/81/818
Unit A25	78	260	40.2 32.0	1/19/81/819
Unit A26	78	260	40.2 32.0	1/19/81/820
Unit A27	78	260	40.2 32.0	1/19/81/821
Unit A28	78	260	40.2 32.0	1/19/81/822
Unit A29	78	260	40.2 32.0	1/19/81/823
Unit A30	78	260	40.2 32.0	1/19/81/824
Unit A31	78	260	40.2 32.0	1/19/81/825
Unit A32	78	260	40.2 32.0	1/19/81/826
Unit A33	78	260	40.2 32.0	1/19/81/827
Unit A34	78	260	40.2 32.0	1/19/81/828
Unit A35	78	260	40.2 32.0	1/19/81/829
Unit A36	78	260	40.2 32.0	1/19/81/830
Unit A37	78	260	40.2 32.0	1/19/81/831
Unit A38	78	260	40.2 32.0	1/19/81/832
Unit A39	78	260	40.2 32.0	1/19/81/833
Unit A40	78	260	40.2 32.0	1/19/81/834

Total Area Comprised in

Authority being Officer of Registrar Bay  
 Registered as a member of an unincorporated body  
 by or under any direction, that the plan and survey are correct  
 and have been made in accordance with the regulations under the  
 Surveyors Act 1982  
 Dated at Auckland this 15th day of May 1984  
 Signatures: *M. S. G. S.*  
 Registrar  
 Reference Plans: *1/19/81/822*  
 Examined: *Correct*  
 Approved as to Survey: *Correct*  
 Deposited this 15th day of May 1984  
 Chief Surveyor  
 District Land Registrar

SHEET 2 of 2  
 LOCAL AUTHORITY: NORTH SHORE CITY  
 Surveyors: A.L. BATES & ASSOCS. LTD.  
 Scale:  
 Date: 15 MAY 1984  
 DP 189 561  
 1982  
 15 MAY 1984  
 District Land Registrar

PLAN OF UNITS ON LOT 16 DP 175192

LAND DISTRICT: NORTH AUCKLAND  
 SURVEY BLK & DIST: VII WAITEMATA  
 NZMS  
 SHEET No.